

2 & 3 DOOR TELESCOPIC

FITTING INSTRUCTIONS

KIT CONTENTS

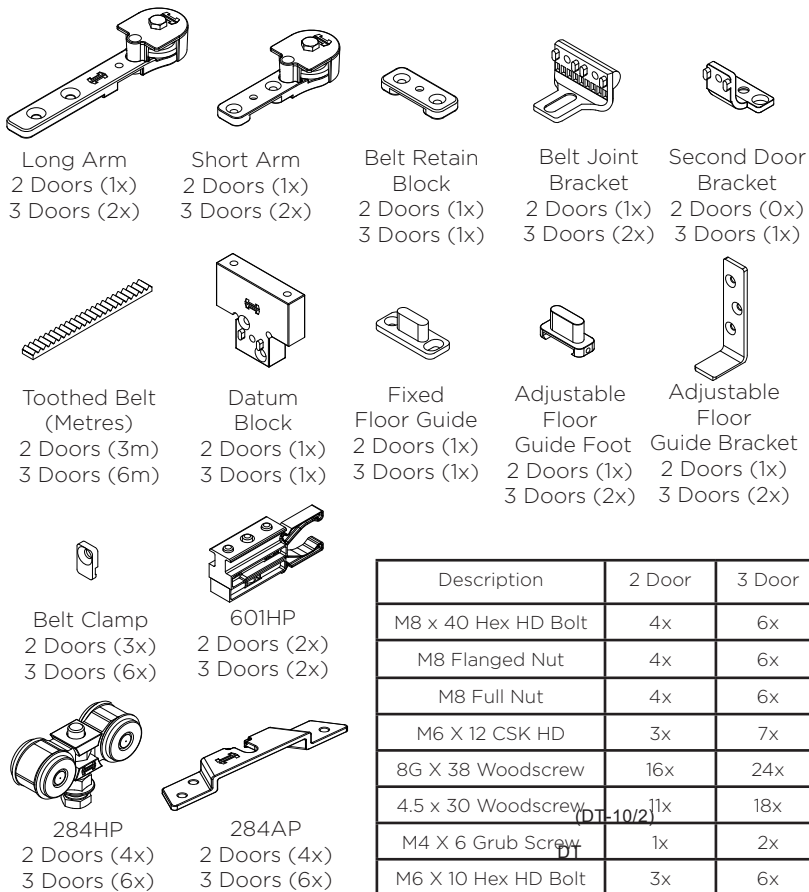

KIT AND DOOR SPECIFICATION

Kit Short Code

TELHP120/2

T TELHP120/3



120kg

W 120kg

TOOLS REQUIRED

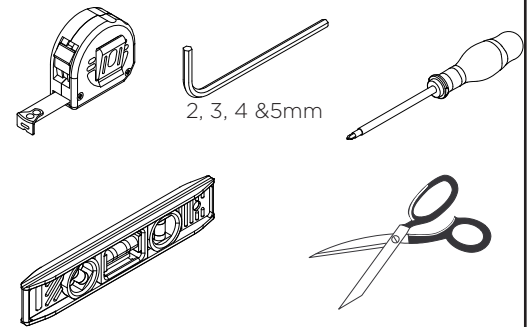

FLOOR GUIDE ROUTING DETAIL

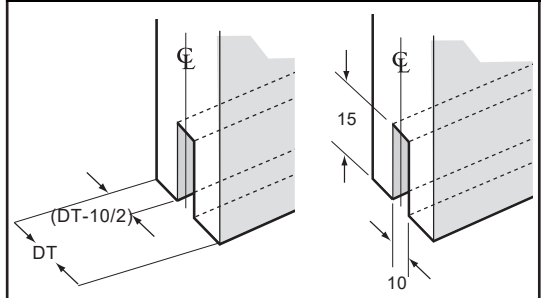

SYSTEM OVERVIEW AND TRACK INSTALLATION

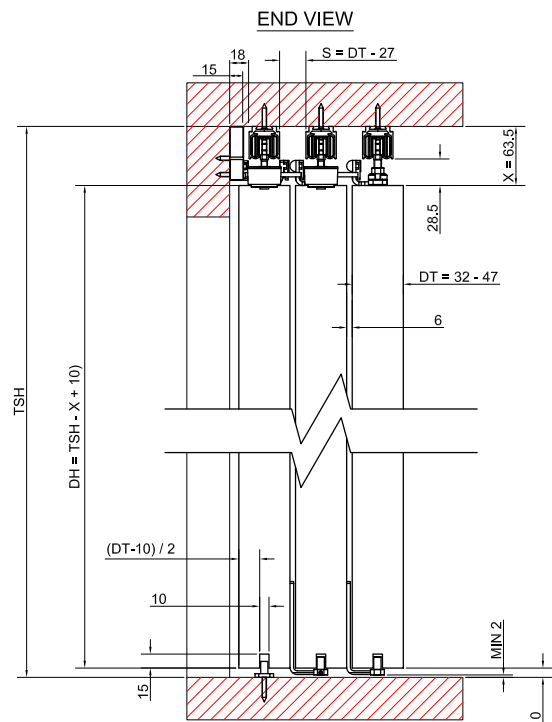
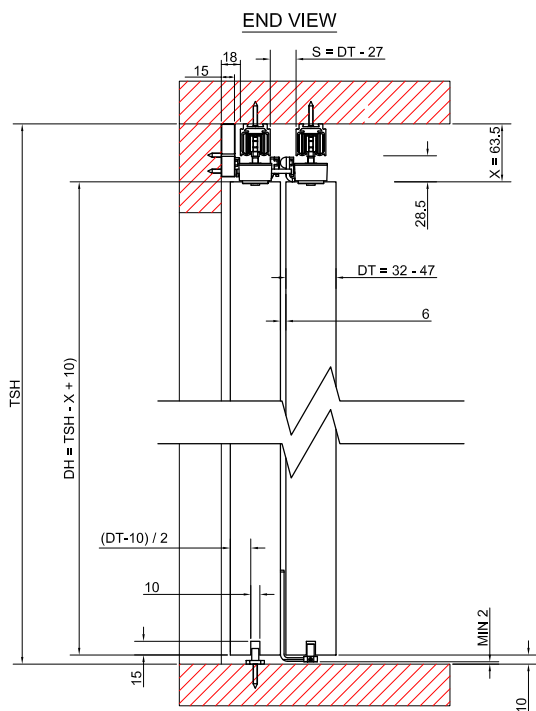

KEY:

DT = DOOR THICKNESS DH = DOOR HEIGHT X = RECOMMENDED TOP CLEARANCE (63.5MM) TSH = TRACK SET HEIGHT S = GAP REQUIRED BETWEEN TRACKS

2 DOOR OVERVIEW

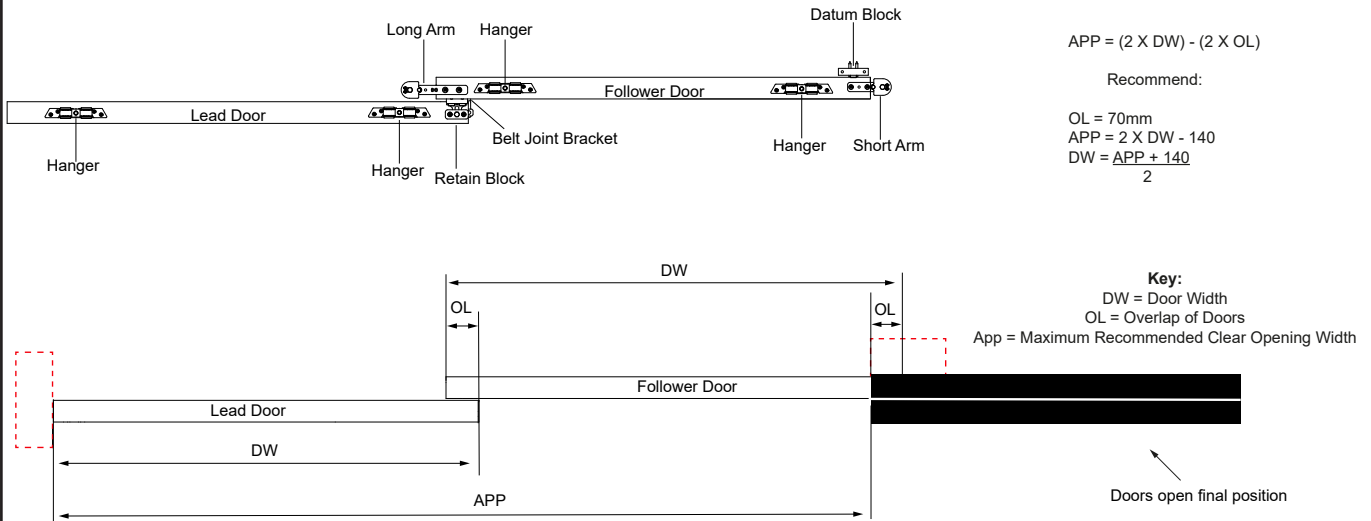

2 DOOR TRACK COMPONENTS

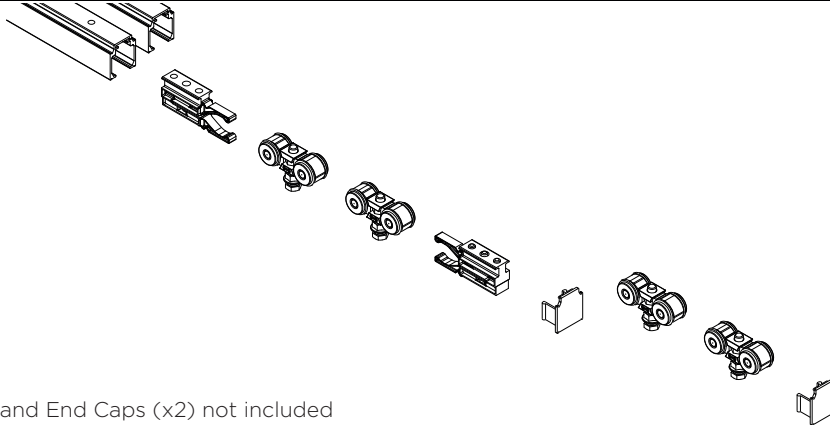

Note: Track and End Caps (x2) not included

3 DOOR OVERVIEW

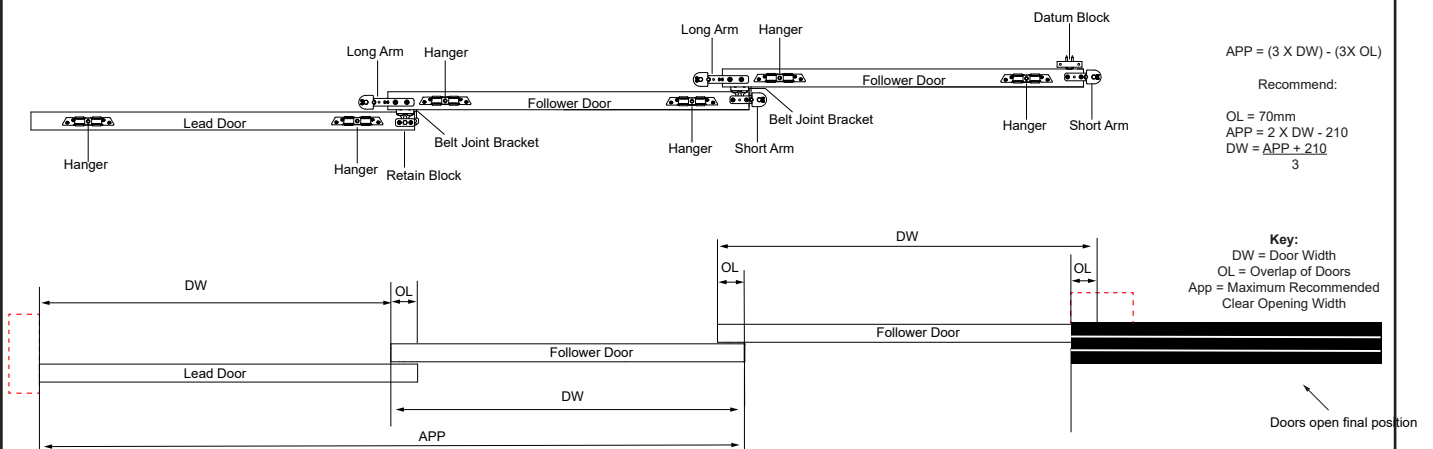

3 DOOR TRACK COMPONENTS

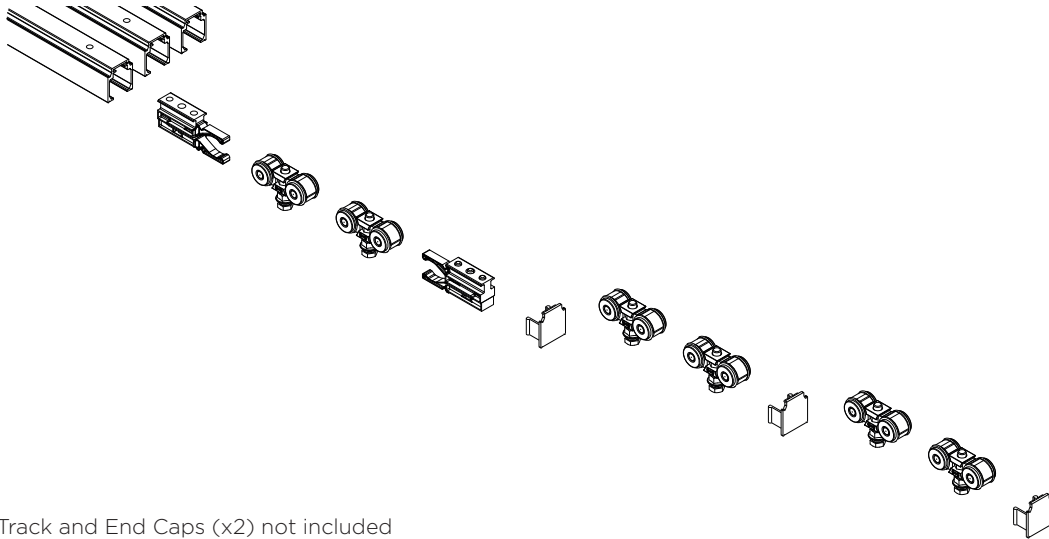

Note: Track and End Caps (x2) not included

1 FIT APRON PLATES.



Note: Use 8G x 38 Wood Screws

2 ATTACH LONG ARM ON FOLLOWER DOOR.

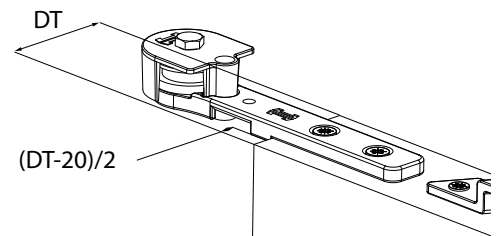

Note: Use 4.5 x 30 Wood Screws

3 ATTACH SHORT ARM ON FOLLOWER DOORS.

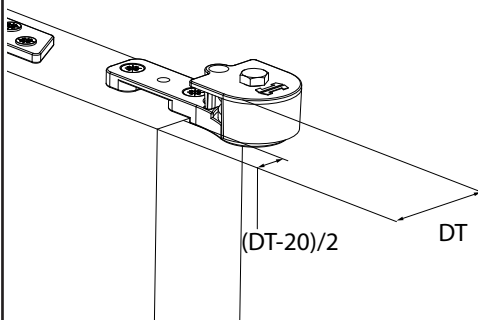

Note: Use 4.5 x 30 Wood Screws

4 REMOVE BEARING CAPS.

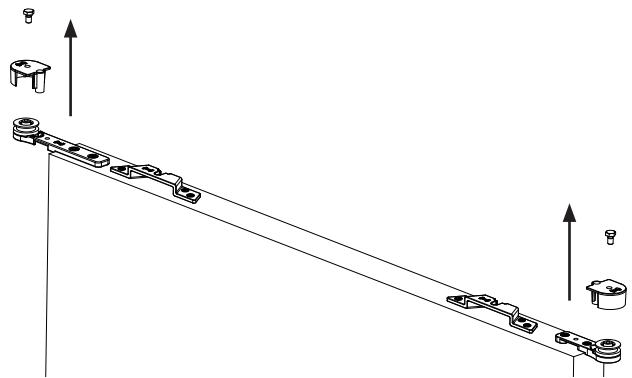

5 LOOP BELT AROUND BEARING WHEELS. CUT BELT TO LENGTH.

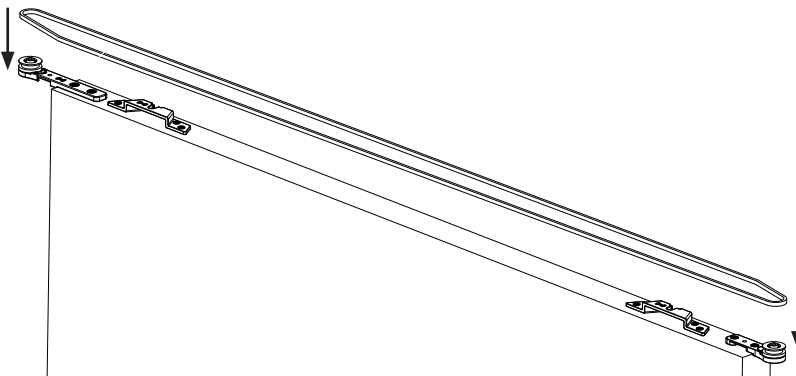

6 ATTACH BOTH ENDS TO BELT JOINT BRACKET.

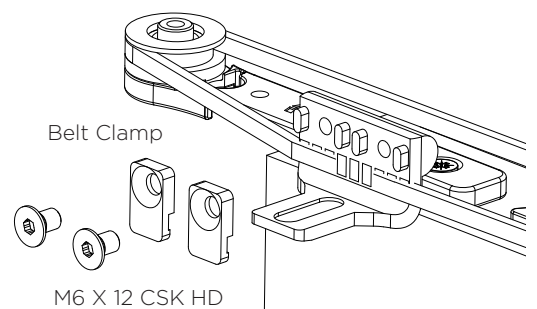

7

CLAMP BRACKET SHOULD BE FREE TO TRAVERSE BETWEEN BEARINGS.

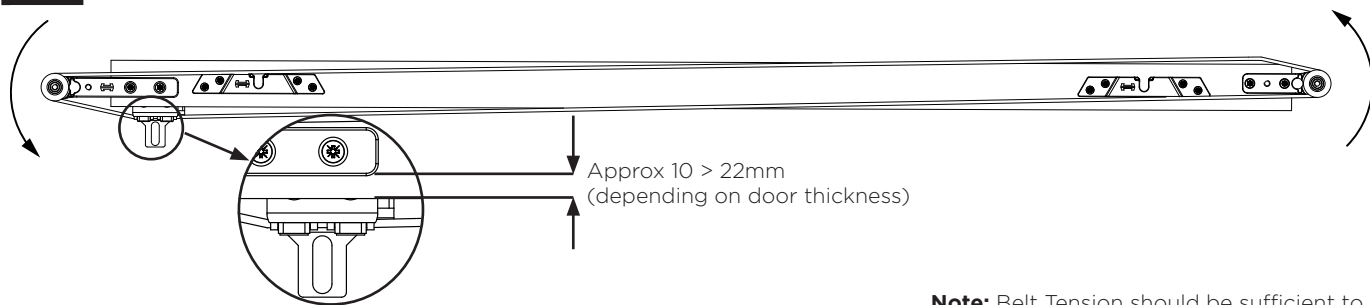

Note: Belt Tension should be sufficient to allow connection between doors

8

RE-ATTACH BEARING CAPS.

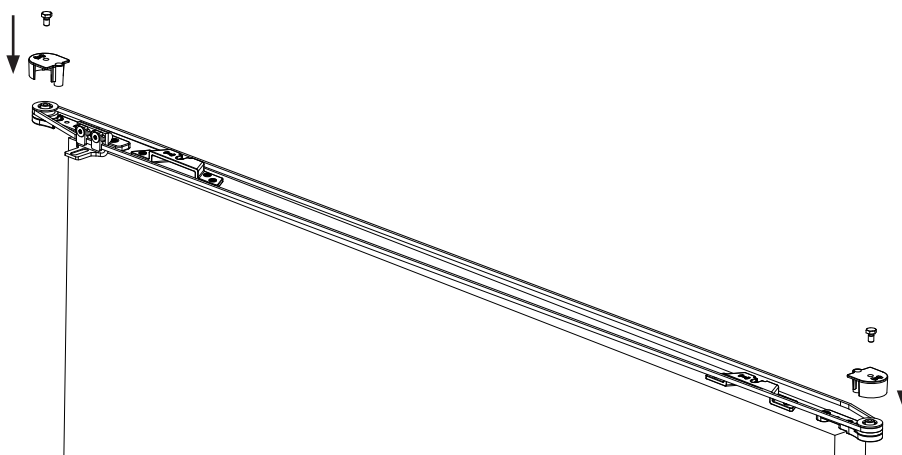

9

POSITION RETAIN
BLOCK ON
LEAD DOOR.

4.5 x 30 Wood Screws

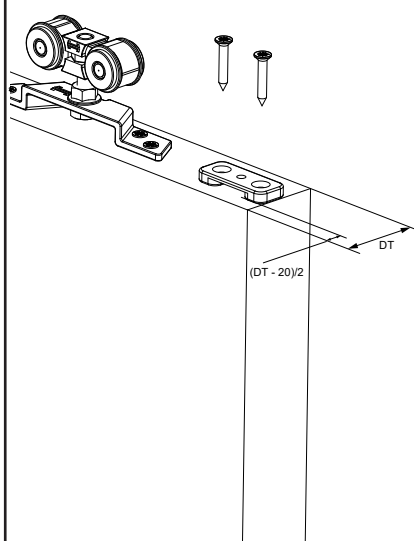

10

FLOOR GUIDE OVERVIEW.

Lead Door

Follower Door

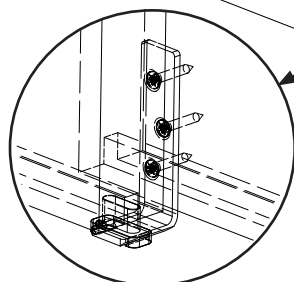

Adjustable Floor Guide

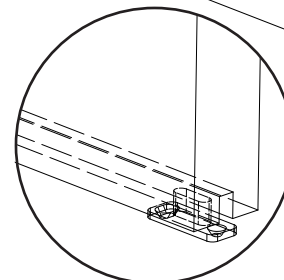

Fixed Floor Guide

11

ALIGN DOORS WITH SPIRIT LEVEL TO POSITION FIXED FLOOR GUIDE.

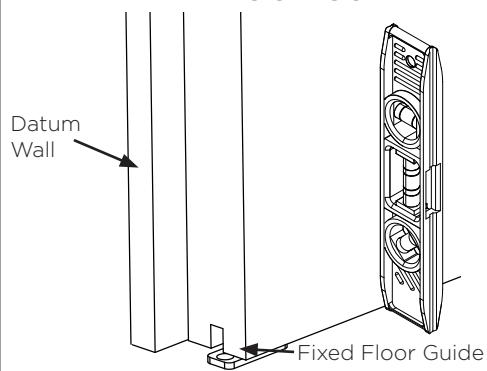

12

POSITION FLOOR GUIDE ON FOLLOWER DOOR.

4.5 X 30
Wood
Screws

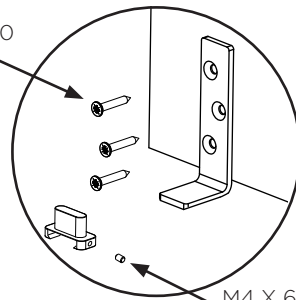

M4 X 6 Grub
Screw

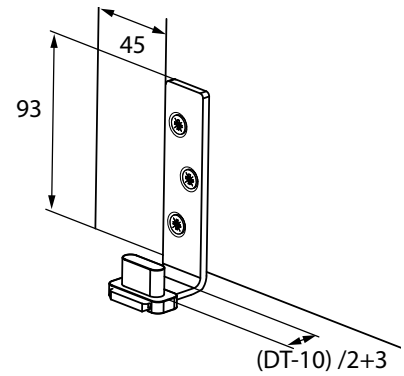

13

HANG DOORS ONTO HANGERS.

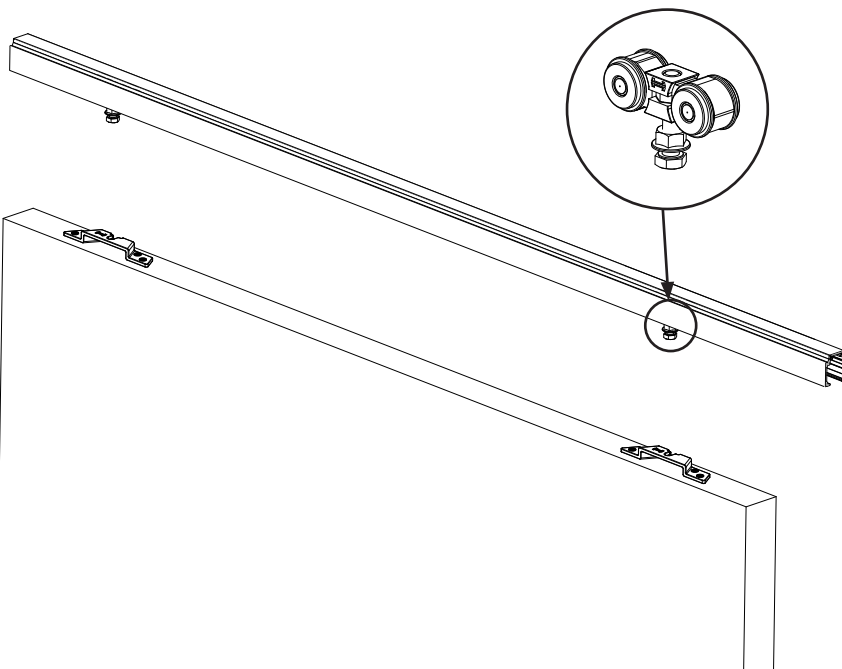

14

SET HEIGHT AND SECURE DOORS TO HANGERS.

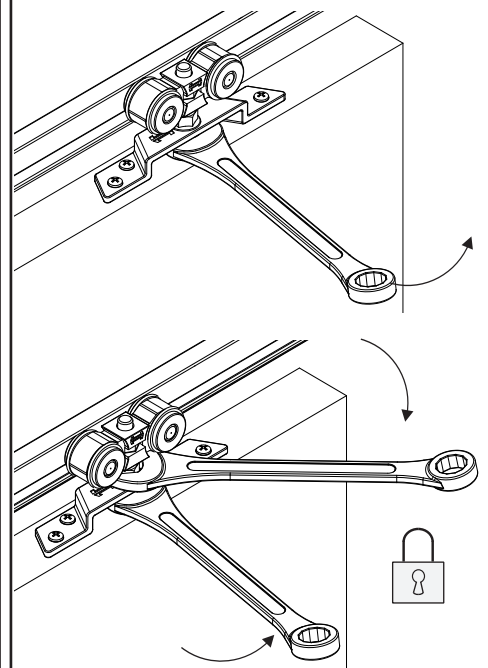

Note: See system overview for set height.

15

ENSURE FLOOR GUIDE IS CORRECTLY ALIGNED.

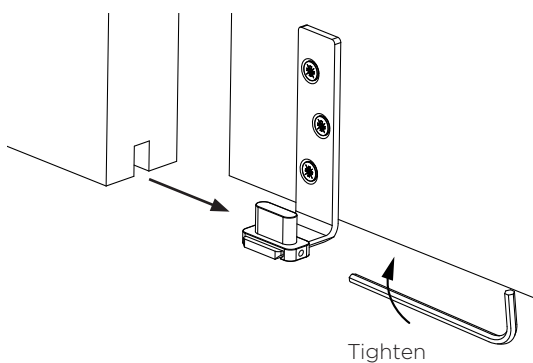

16

CONNECT DOORS.

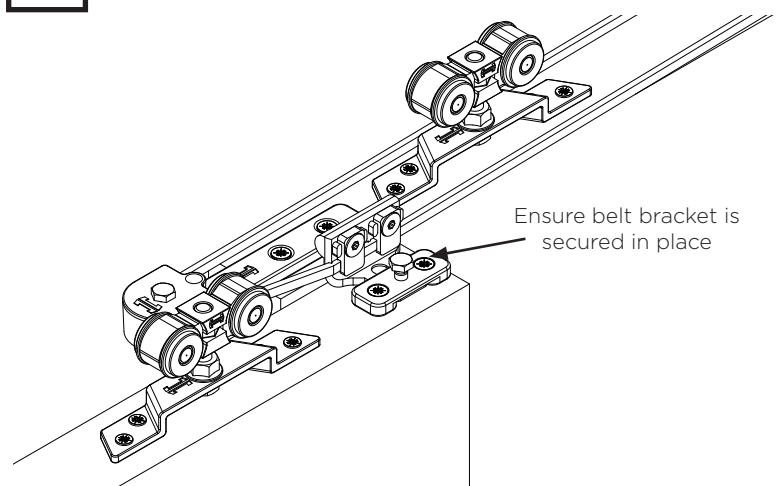

17 2 DOOR AND 3 DOOR BELT OVERVIEW.

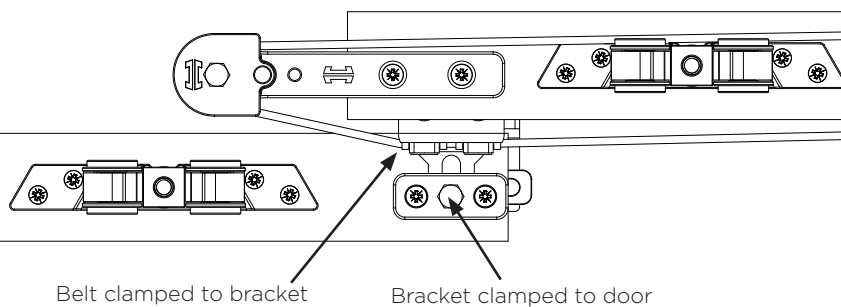

18 **3 DOOR SYSTEM ONLY.**
ADD SECOND DOOR
BRACKET TO LONG ARM.

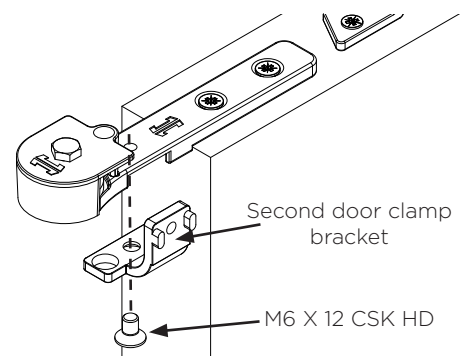

19 **3 DOOR SYSTEM ONLY.**
CONNECT DOORS.

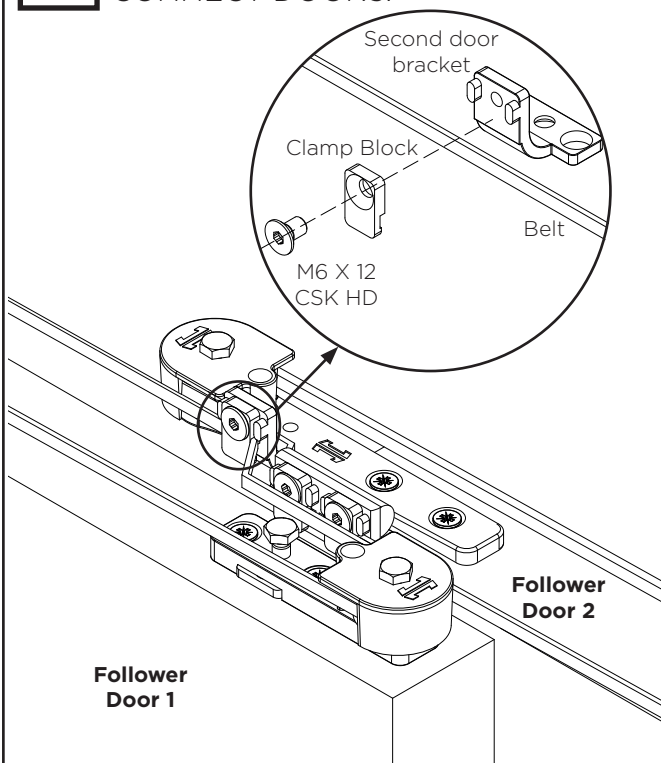

20 **3 DOOR SYSTEM ONLY.**
BELT CONNECTION OVERVIEW.

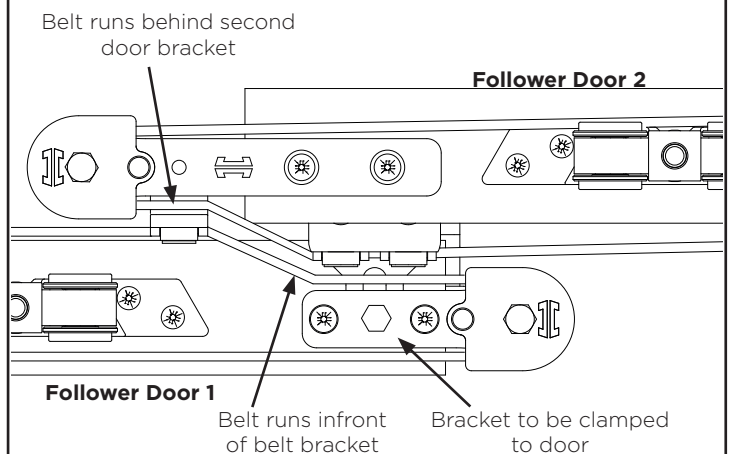

21 WITH DOORS IN FULLY CLOSED POSITION, MARK POSITION FOR DATUM BLOCK.

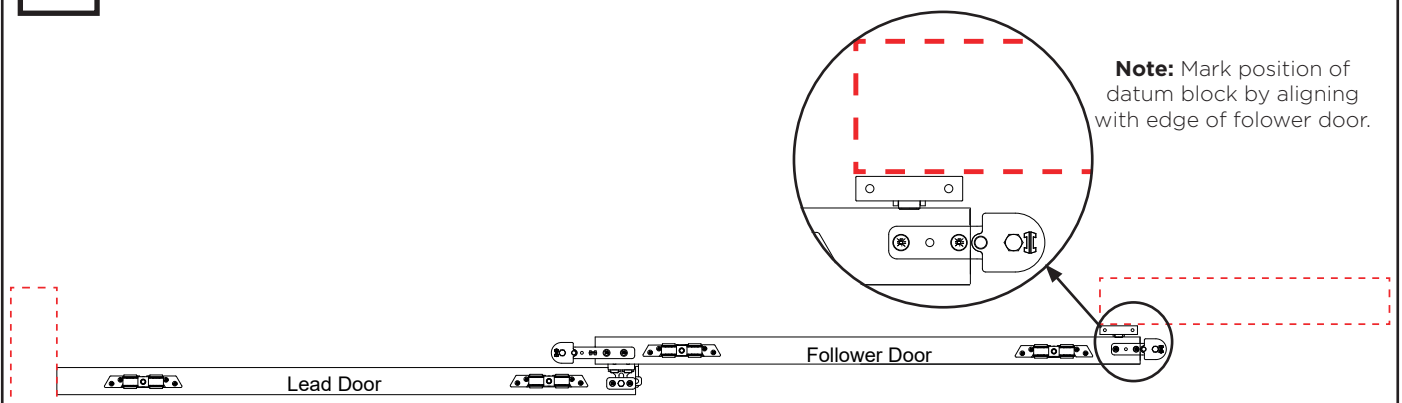

22

AFFIX DATUM BLOCK. ENSURE DOORS ARE ABLE TO FULLY TRAVERSE THE TRACK.

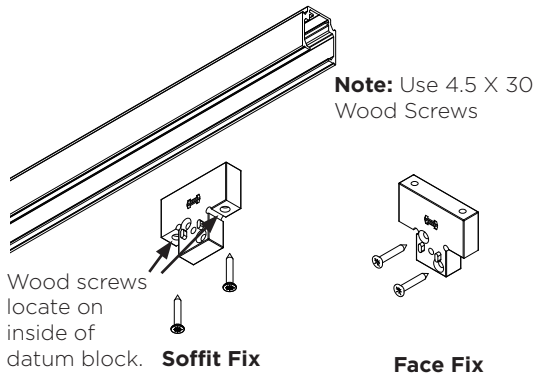

23

CONNECT BELT TO DATUM BLOCK.

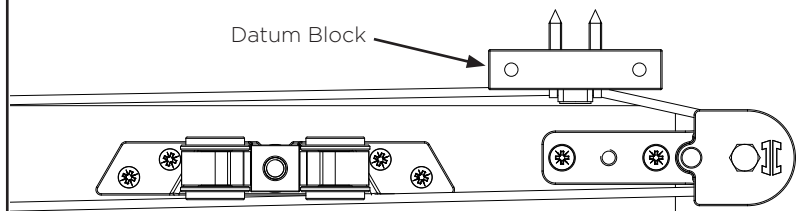

24

WITH DOORS IN FULLY CLOSED POSITION, LOCATE THE CLIP STOP BY SLIDING THE STOP UP TO THE LEAD DOOR HANGERS. SECURE IN POSITION.

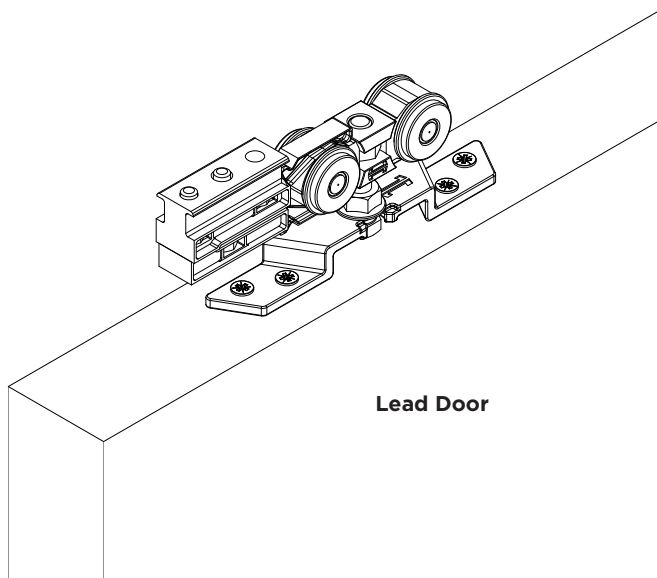

25

WITH ALL DOORS ALIGNED IN THE OPEN POSITION, LOCATE THE CLIP STOP BY SLIDING THE STOP UP TO THE LEAD DOOR HANGERS. SECURE IN POSITION.

